

EASY PARSE FOR GS1

TotalFreedom Plug-In

GS1 is an international not-for-profit association dedicated to the development and implementation of global standards and solutions to improve the efficiency and visibility of supply and demand chains globally and across multiple sectors

The GS1 system of standards is the most widely used supply chain standard system in the world. Organizations in many industries—including retail, healthcare, transportation and logistics, consumer electronics manufacturing and defense—need to achieve compliance with various GS1 Sunrise initiatives in order to maximize efficiency and maintain positive trade relationships.

Honeywell's EasyParse™ for GS1 software plug-in parses application identifiers (AI) found in various bar code symbologies as outlined in the GS1 General Specifications, and delivers the selected data sets in the format supported by the host application.

Powered by Honeywell's TotalFreedom® open-system architecture, EasyParse for GS1 eliminates the need for host system software to recognize the AIs contained within select bar code symbologies found on various items.

EasyParse for GS1 can be installed on various area-imaging scanners, or purchased as a standalone upgrade via SKU TF2-EZGS1. An easy-to-use PCbased utility allows you to select the desired data set and data format. After installing the plug-in, a simple programming sequence enables you to parse application identifiers in any order you choose. Separate fields by selecting any of the available delimiters.

When you enhance a Honeywell imager with EasyParse for GS1, you've just taken an important step toward achieving improved accuracy, increased efficiency and GS1 compliance.



COMPATIBLE WITH THE FOLLOWING PRODUCTS

Xenon XP Family

Voyager Family

VuQuest 3320g

Genesis 7580g

Solaris 7980

Granit Family

Orbit 7190g

Seychelles 8680i

Stratos 2700

Document reader 4850DR

*If you do not see your device, please contact Honeywell Tech Support

FEATURES AND BENEFITS



ACHIEVES INDUSTRY COMPLIANCE

Facilitates compliance with GS1 Sunrise initiatives—including GS1 Sunrise 2010, 2012 GTIN Sunrise, and GS1 Sunrise 2014 — by configuring EasyParse for GS1 to recognize the application identifiers found in select bar code symbologies.



ENABLES ACCURATE DATA CAPTURE

Improves operations by allowing host systems to correctly capture the data encoded in select bar code symbologies through use of available application identifiers.



OFFERS EASE OF INTEGRATION

EasyParse for GS1 is installed directly on the scanner, eliminating the need to make costly and time-consuming changes to the host application software

Honeywell

EASYPARSE FOR GS1

EasyParse for GS1 can be used by a wide variety of organizations in industries that utilize the application identifiers (AI) found in GS1 bar codes:

- Retail
- Healthcare
- Transportation and logistics
- Consumer electronics manufacturing
- Defense.

APPLICATION EXAMPLES

Honeywell's EasyParse for GS1 plug-in benefits organizations involved in various applications, including:

- The implementation of GS1 DataBar™ codes in retail to achieve compliance with GS1 Sunrise initiatives (2010 for produce and 2014 for meat)
- Checking the expiration date on food and other non-perishables items
- Managing supply chain information, such as cost per unit and the number of items in a unit
- Tracking and tracing items
- Accepting coupons

TYPES OF INFORMATION ENCODED

- **Item Descriptors:** GTIN, batch, serial number, meat cuts
- **Date Descriptors:** Production, packaged, best before, expiration
- **Measure Descriptors:** Weight, dimensions (height, width, length), area, count
- **Currency Descriptors:** Currency amount, price, price per unit
- **Transaction Descriptors:** GLN extension, order number, consignment number, shipment number, bill to, ship to, country of origin, order processor, NATO stock number
- **Coupon Descriptors (North America only):** Coupon ID, offer details, offer expiration, North American coupons & global coupons
- **Mutually Agreed Descriptors:** Fields pre-arranged between trading partners

BAR CODE SYMBOLOGIES WHICH SUPPORT APPLICATION IDENTIFIERS

- GS1-128
- GS1 DataBar Composite Codes (e.g., Limited, Stacked, Stacked Omni, and Expanded)
- GS1 DataBar
- GS1 Data Matrix

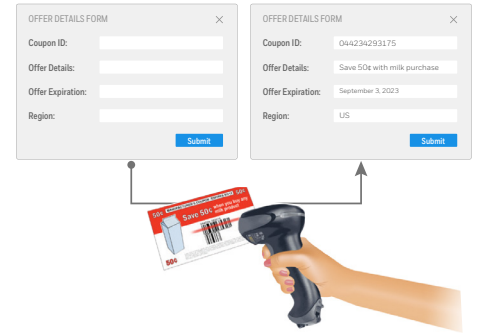

Easily parses GS1 application identifiers

AVAILABLE FIELD DELIMITERS				
ASCII CHARACTER SET				
NUL	SOH	STX	ETX	EOT
ENQ	ACK	BEL	BS	HT
LF	VT	FF	CR	SO
SI	DLE	DC1	DC2	DC3
DC4	NAK	SYN	ETB	CAN
EM	SUB	ESC	FS	GS
RS	US	SP	!	"
#	\$	%	&	'
()	*	+	,
-	.	/	0	1
2	3	4	5	6
7	8	9	:	;
<	-	>	?	@
A	B	C	D	E
F	G	H	I	J
K	L	M	N	O
P	Q	R	S	T
U	V	W	X	Y
Z	[\]	^
_	'	a	b	c
d	e	f	g	h
i	j	k	l	m
n	o	p	q	r
s	t	u	v	w
x	y	z	{	
}	~	DEL		

For more information

www.honeywellaidc.com

Honeywell Safety and Productivity Solutions

300 S Tryon St Suite 500
Charlotte, NC 28202
877-841-2840
www.honeywell.com